

Saga Palvelutalo Salpalinna

Kyösti Kallion katu 3, 15110 Lahti

1H+KT+parveke, 27,5m²

B220, 2.KRS

B320, 3.KRS

B420, 4.KRS

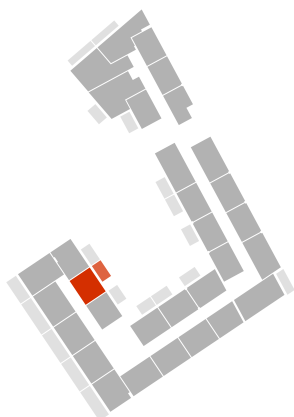
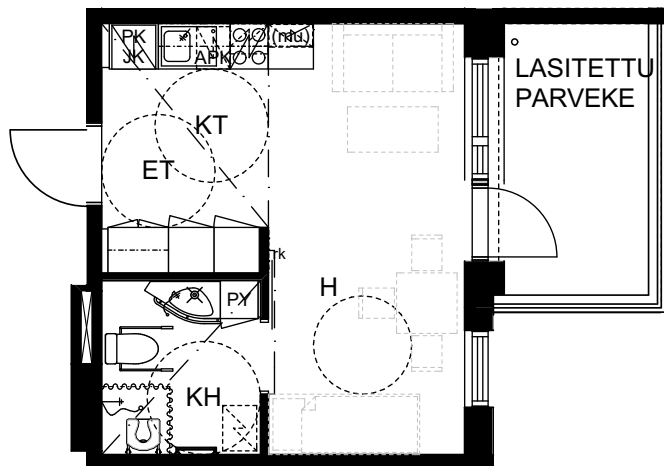

KERROKSET 3-4

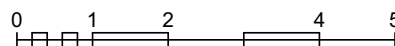

MITTAKAAVA 1:100

HUONEISTOPOHJA

05.12.2018



ARKKITEHTIPALVELU .fi